

FIS

INNOVATION AWARDS

thefis.org

FIS INNOVATION AWARDS 2024

The FIS Innovation Awards showcase outstanding innovation in the finishes and interiors sector across four different categories: Product Fit-Out, Product FF&E, Digital and Sustainability.

The winners were announced in front of a live audience at the FIS Conference on 27 February in London.

All entries were independently assessed by a panel of expert judges and the winner of each category was announced in front of a live audience at the FIS Conference.

The winner of each category was then invited to deliver a short pitch on their innovation to the audience, who then determined the overall 2024 Innovation of the Year winner.

ENTER THE 2025 AWARDS

Entry for the 2025 Awards will open in April 2024.

We are on the lookout for innovation that meets a need in the finishes and interiors sector, and has evidence of adoption or planned use in a commercial environment. By innovation, we mean the successful exploitation of new ideas and bringing creative ideas to life.

Our focus is on ideas that help to support improvements in efficiency, productivity, performance, quality or perception of the finishes and interiors sector.

The Awards are open to all companies operating in the finishes and interiors sector, regardless of size. To qualify, innovations should have been introduced to the UK market in the last five years.

Find out more at thefis.org/membership-hub/fis-awards/innovation/



+44(0)121 707 0077
info@thefis.org
thefis.org

JUDGING PANELS

SUSTAINABLE INNOVATION

Elina Grigoriou

Design and Sustainability Director
Grigoriou Interiors

Mark Catchlove

Director, MillerKnoll
Global Insight Group

Flavie Lowres

Sustainability Champion
FIS

DIGITAL INNOVATION

Diane Tocco

Founder and BIM Consultant
Diane Butterworth Ltd

Helen Gawor

Director of Strategy Implementation
and Innovation
ISG

Chris Grant

Projects & Partnerships Manager
Digital Construction Skills

Dr Bola Abisogun OBE

Founder and CEO
Digital Twin Skills Academy CIC

John Roberts

Engineering Consultant
Priestland Consultancy

PRODUCT INNOVATION - FIT-OUT

Vanessa Brady OBE

Founder and CEO
The Society of British and International
Interior Design

Helen Gawor

Director of Strategy Implementation
and Innovation
ISG

Matt Taylor

Director
Taylor Design Consultancy

Karen Berridge

New Product Development Manager – Specialist
Markets, SIG

Joe Cilia

Technical Director, FIS

PRODUCT INNOVATION - FF&E

Vanessa Brady OBE

Founder and CEO
The Society of British and International
Interior Design

Matt Taylor

Director
Taylor Design Consultancy

Karen Berridge

New Product Development Manager –
Specialist Markets
SIG

Joe Cilia

Technical Director
FIS

IOBAC contamination-free Flooring Installation Tabs

Floor coverings installed using wet applied adhesives can be difficult to reuse or recycle on uplift due to contamination from adhesives. This results in flooring being sent for incineration or landfill, and significant rectification work to the sub-floor before the next installation.

IOBAC Flooring Installation Tabs address this issue by enabling floor coverings to be affixed securely throughout the life of the installation, yet cleanly and easily uplifted.

These reversible fixing mechanisms give flooring a second life, vastly improving flooring circularity and making flooring manufacturers' take-back schemes easier to implement.

Building assets such as raised access flooring and concrete subfloors are protected from damage, with the additional embodied carbon associated with new materials avoided.

IOBAC Tabs are used for installation of carpet tile, +4mm Luxury Vinyl Tile and woven vinyl tiles onto all common prepared sub-floors. They are a universal fixing system meaning adhesive-free design is not limited to a particular flooring type or brand.

The range consists of two products, both combining high grab with clean removal:

- IOBAC MagTabs® for use on metal raised access flooring and IOBAC's range of magnetically receptive underlays and resins, was launched in 2019 and was the winner of 2019 Flooring Innovation Award and finalist in 2023 ASBP and Sustainable Design Collective Awards. They are clever little squares, magnetic on one side and self-adhesive on the other, incorporating IOBAC's patented Dual Grip technology which combines dry-tack adhesion with magnetism for phenomenal grab, even in high footfall areas.
- IOBAC Tab-It® for use on non-metal raised access flooring (including calcium sulphate, aluminium and wood), concrete, wood, ceramic and vinyl sub-floors was launched in September 2023.

Judges' comments

The scale of the potential of IOBAC is particularly interesting considering the amount of floor covering and raised access flooring used in buildings. IOBAC is a great product that can really support the reuse of floor tiles and raised access flooring, thereby increasing their useful life. It seems very easy to apply and has demonstrated some impressive figures.

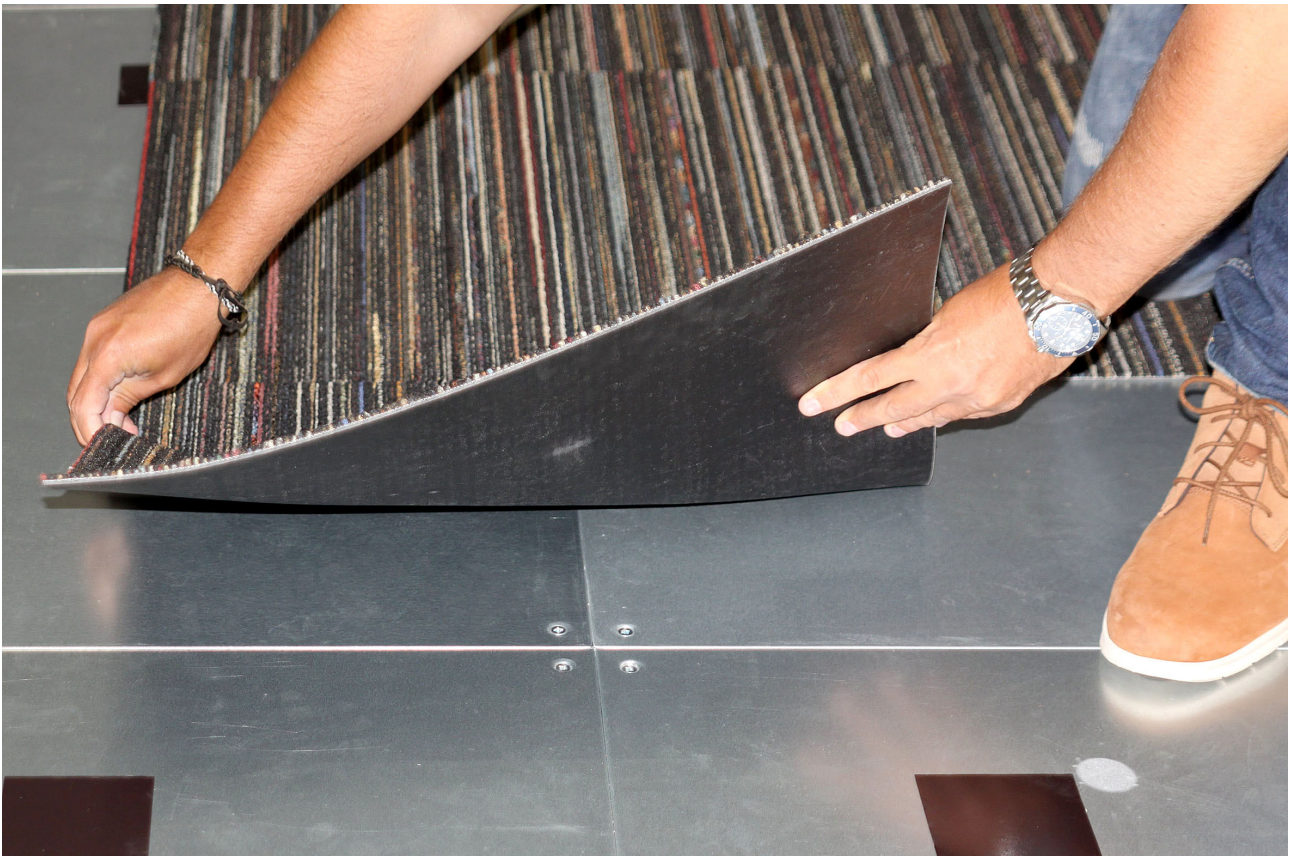
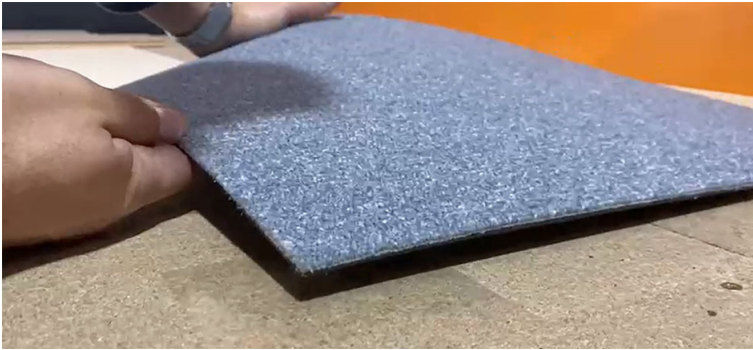



PROTEKT[®] by **PROTEKTOR[®]**

Building a Sustainable Future



RESPONSIBILITY

Protektor Group UK ensure materials come from long lasting and economical sources.



INNOVATION

We innovate a more sustainable future, ensuring the products created and the processes used to create them are sustainable



SUSTAINABILITY

With a knowledge of decarbonisation and a wealth of technology at our disposal, we partner with UK construction to deliver products beyond the sustainability baseline.



FUTURE

Protekt is at the forefront of all that we do! Enabling us to secure a healthy future for generations to come.



MAXI-TEC[®]
SUSTAINABLE DRYWALL



More Responsibility,
Less Impact



100%
RECYCLABLE



18%
LIGHTER



18%
LESS RAW
MATERIAL



1.5 EPD MAT-2



REDUCED
CO₂

Learn more about our innovative products: www.protektor.co.uk



Optima Glass Partitions manufactured with Hydro CIRCAL aluminium

Optima has adopted Hydro CIRCAL aluminium in its glass partitions and door systems. The lowest embodied carbon aluminium product currently available on the market, Hydro CIRCAL has significantly reduced the carbon impact of its products. Renowned for containing a minimum of 75% post-consumer scrap this low-carbon aluminium is a testament to the sustainable future of manufacturing.

With an embodied carbon of 2.3kg per 1kg of aluminium, Hydro CIRCAL has the lowest carbon footprint of any aluminium commercially available today. By adopting Hydro CIRCAL into its systems, Optima has inherently engrained the circular economy into its glass partitioning solutions.

Optima is committed to backing up its environmental claims with hard evidence and as a result has developed individual Environmental Product Declarations (EPDs) for its entire product range which are freely available on its website. Since the adoption of Hydro CIRCAL it has also created Carbon Calculation Reports which set the lower embodied carbon aluminium forecast values and can be found at the end of each EPD.



With a minimum of 75% post-consumer recycled content



Judges' comments

The change of aluminium provider to use one with less carbon and high recycled content is a simple change with an impressive impact. It achieves huge saving in embodied carbon and supports the responsible agenda by avoiding the mining of raw materials. The creation of EPDs further enhances Optima's commitment to the environment.

Selo/Tempus temporary fire doors

Tempus are reusable, zero maintenance, E60 fire-rated temporary doors. Constructed from heavy-duty steel with a mineral wool core, they are designed to withstand the rigours of a construction site whilst maintaining fire compliance throughout. The insulated core means that they are not affected by moisture intake and can be unscrewed, removed, and reused.

The pre-hung unit makes installation and relocating extremely fast. The doorset is face-fitted to the wall, which ensures the doorset can accommodate varying opening sizes and tolerances. E60 fire rated, they have an inert patented locking system which automatically activates when in direct contact with fire typically between 100-200°C.

Tempus can be reused time and time again on multiple projects and by reusing the doorset the waste associated with traditional temporary doors can be significantly reduced.

Judges' comments

Tempus is not only a more durable and reusable solution, but it is also important as fire doors can save lives.



PlanRadar

PlanRadar is a SaaS field management platform specifically designed for the intricate needs of construction and real estate projects, including task management and communication for robust project oversight. Operating through a cloud platform, it allows users to easily document and record vital project data, creating an all-important golden thread of information.

Fundamentally, it's a tool for anyone looking to improve the safety, quality and efficiency of builds, whether new builds or renovation and retrofit projects.

The software goes far beyond data entry and recording, serving as an all-encompassing solution adapted to the fast-paced nature of the fit-out sector, adept at navigating the complexities of existing building surveys or condition surveys, snagging at the beginning and end of projects to reduce the likelihood of reworks, managing subcontractors and enabling the easy reporting of vital project information for a comprehensive audit trail.

Simple to use and intuitively designed, users can efficiently manage surveys and snag reports, ensuring full safety and compliance. It also improves condition reporting, a vital and time-consuming element in fit-out and renovation, through evidence collection and secure storage.



Importantly, users can capture critical visual data in the form of voice notes, photos and videos while live

on-site, with the ability to geotag each image for pinpoint plan accuracy.

Looking ahead, there are plans to integrate a common data environment (CDE) into the platform for additional project management capabilities.

PlanRadar is available in 20 languages to a user base exceeding 120,000 from 75 countries.



Judges' comments

PlanRadar has linked all the data being produced by fit-out contractors onsite to quickly and accurately create the reporting they need. They have worked closely with end users to incorporate the specific needs that their surveys and construction require. Brought in line with the Building Safety Act with measurable impact demonstrated this is a well thought out product.

VERTUS



APARTMENTS TO RENT BUILT BY



CANARY WHARF
CONTRACTORS

WWW.THISISVERTUS.COM

Zentia/Sonify 3D Studio

By combining parametric design and creativity with simple integration into digital workflows, Sonify 3D Studio provides a simple, risk-free process to design discontinuous suspended ceilings. It considers the entire sales process from inspiration and design through to installation providing a seamless specification experience.



Sonify 3D Studio was specifically designed to support architects and specifiers with digital planning and parametric design to help make ambitious, large scale and complex discontinuous ceilings simple and risk-free to specify.

It offers customers the ability to deliver design-led, high performance acoustic ceiling systems in large open spaces, whilst adhering to the Golden Thread, by being able to download files straight into digital workflows and create a bill of materials ready to be delivered to site.

Architects and specifiers can create as many designs as they wish within five pre-loaded environments and an additional customisable room to deliver design-led, high performance acoustic ceiling baffles, rafts, and canopies in a variety of spaces.

Judges' comments

A useful tool which clearly functions beautifully, this solution shows the realistic visualisations that can rapidly be generated by users for review. It would benefit from improvements in aspects such as sustainability, commercial impact, and acoustic/sound calculations to broaden its appeal.



Etex/mySiniat

In response to the implementation of the Building Safety Act and the mandated requirement to provide and maintain a 'golden thread' of performance data, Siniat has devised an innovative tool to ensure its customers and partners can access all required technical performance data for any project, from anywhere.

mySiniat provides a space for architects and specifiers to digitally explore, learn and plan drylining packages using the manufacturer's extensive range of products and systems, while also being able to benefit from the combined reassurance of its technical team's expertise.

Using mySiniat gives partners and suppliers exclusive access to technical content not currently available on the manufacturer's website. This includes CAD files, fire and acoustic reports, datasheets and more in a virtual library, meaning that all resources are readily accessible for users in just a number of clicks.

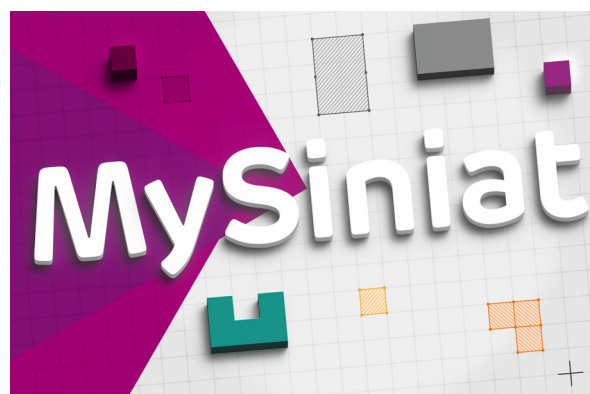

The platform also enables users to access Siniat's expertise and product data in a format that means systems can be designed, created and specified, online to the point where they are ready to be assembled. This forms a foundation that supports success, designs out risk, and ensures compliance with the legislation laid out in the Building Safety Act.

Judges' comments

A great resource in line with changing legislation, mySiniat has addressed a key industry issue, the Building Safety Act, and provided a tool that collates the information required for Siniat's product range. A great project workflow for Building Safety Act compliance that could go further.

Fire Stop Products/Speed Cutter

Yet to be launched, Speed Cutter is a new solution to reduce the time, cost and skills required to fit fire resistant penetrations to drylined walling.

Currently there is a three-step process to fit a penetration. The dryliner fits a 'letter box' in the existing structure, the services team then fits the required pipework or cable etc and the penetration then requires fire stopping by a fire stopping expert. These three steps require several site visits and coordination between several agents. Speed Cutter can easily be fitted by any of these trades and provides an initial and future penetration.



Fire Stop Products has taken an existing design and worked with the product owner and various manufacturing partners to develop a product that can be manufactured in significant volumes and provide an ongoing market ready solution.

Using Speed Cutter, timed installs show that a full penetration, including mechanical fixing can be fitted in less than two minutes. It is anticipated that it will significantly reduce the time, cost and complexity of installation fire resistant penetrations. This is expected to be both a first and second fix product.

Judges' comments

The Speed Cutter focuses on a well-known problematic area of the installation process and the challenges of co-ordinating trades when forming service penetrations. Reducing the necessity of framed openings is a great focal point for this product, with its time saving and clean finish making it so much easier for a single trade to use. More technical data around where it can be used would be advantageous.

DIGITAL DELIVERY NEXT LEVEL SERVICE

The launch of our new Digital Electronic Proof of Delivery in March is part of our sustainability objectives and it will take our delivery network to the next level. The streamlined process works with ease, bringing simplicity and additional peace of mind to all our customers.

With large comprehensive stock availability, you can get the insulation, drylining and screeding materials you need for your next project on site, on time. With coverage across much of the UK, we're setting the pace for others to follow.



SCAN ME



Let's talk about what you need: 01733 202996
sales@epdinsulationgroup.co.uk
epdinsulationgroup.co.uk



Global Ceiling Services/Teg Clip

The Teg Clip replaces infill blocks and allows the tegular edge of a ceiling tile to safely sit as intended by providing an infill support at the perimeter junction of a ceiling grid. Made from mild steel powder coated it has an A1 classification for reaction to fire.

The traditional way of fitting ceiling tiles to perimeters is to re-form the rebate edge with one cut to get the tile size and a further two cuts to create the manual rebate. The clip improves productivity by reducing the labour time of the perimeter cutting of ceiling tiles from a three stage application to a single stage process.

The quality of the clip when the ceiling is complete gives a very good quality professional finish. It also has an aftercare benefit as the ceiling tile will re-sit easily into place after maintenance.

It is anticipated that the Teg Clip will be widely used in the suspended ceiling installation.

Judges' comments

An entrepreneurial approach to solving a problem, the Teg Clip is a disruptor in an established market, solving an old problem brilliantly. It appears to be a product that could be simply introduced, without introducing major changes to the ceiling system, or specification, therefore enhancing installation speed of the system without the introduction of additional quality risk.

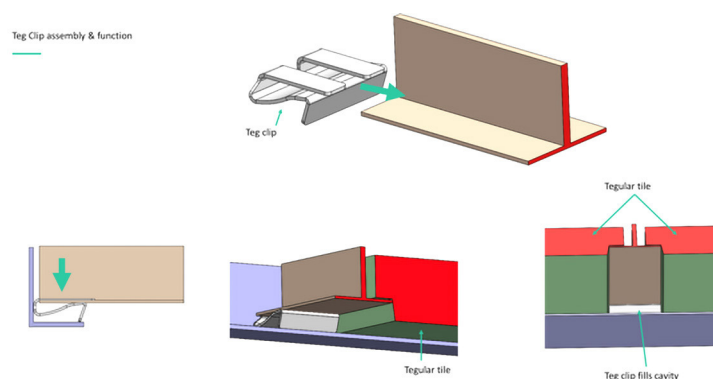

Seamless Abutment Solutions/Cross Stud

Cross Stud is a prefabricated offsite element designed to revolutionise construction of drylining. It utilises geometry and acoustical manipulation to offer a new option in the fit-out and drywall sector. It was developed based on the creator's extensive experience in the construction industry recognising the need for change.

In the global partitioning market, systems are currently built using a combination of U-shaped tracks fixed to the floor and soffit. As a cross shape, this new configuration allows further layers of material such as a plywood pattress or plasterboard to be easily fixed to the rebated/cut out face allowing for the option of reducing the thickness of the overall construction.

Judges' comments

Cross Stud provides an innovative approach to the inclusion of ply within drylining wall systems, whilst a 'resilient' disconnect between the two profile sections is included on the basis of reducing acoustic flanking.

THE CROSS STUD

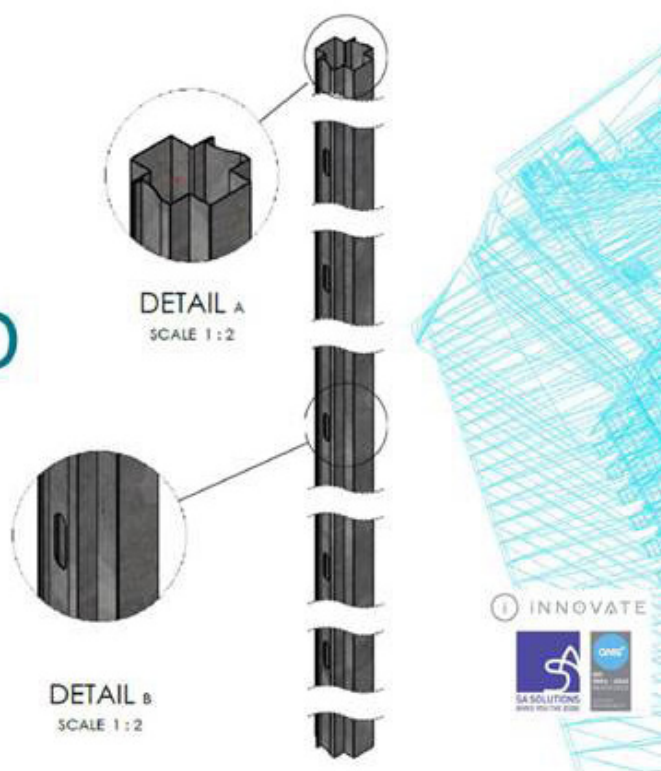

WINNER



sponsored by
**SPEC
FINISH**

Box Strap

Box Strap is a bracket that perfectly mounts metal backboxes in closed stud walls. It guarantees the metal back box sits 6mm away from the finished wall on a single-layer plasterboard of 15mm thickness and 9mm on a double-layer plasterboard. For example, the fire-rated walls between apartments or backing into communal hallways.

The bracket doesn't clash with the baffle box details of the plasterboard manufacturers as it is fixed behind the plasterboard instead of across the studs. An electrical metal back box can be installed with both sides of the walls closed allowing the dryliner to close the walls without having to cut around metal back boxes. In addition, this means that the drywall system is no longer bonded to the electrical earthing system which is something that can happen with the traditional method.

The bracket helps reduce the making good required around switches and sockets that is caused by the difficulty of cutting around metal back boxes while closing the walls. The cutting out is now done by the electrical contractor when the walls are closed.

As the bracket is fixed to the back of the plasterboard instead of across the studs, it can help improve the drywall system performance as it reduces the chances of sound/noise transfers between studs at different heights where sockets or switches are installed. It can improve the fire barriers between the metal backboxes and plasterboard walls, as it allows for a perfect cut around metal backboxes every time.

Judges' comments

A very practical solution for something that is a regular problem for deep and shallow fix back boxes. The retrofit aspect alone, which allows for increased functionality and flexibility of layout, is a clear advantage to this product. A lot of collaboration with alternative big brands made this the winner.

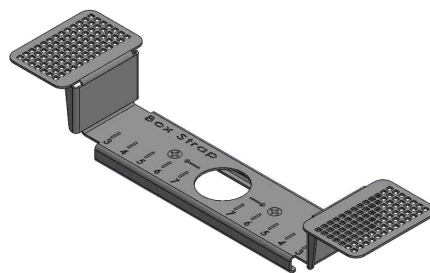

WHERE INNOVATION BEGINS

Reduce your carbon footprint by **2,843kg** of CO2 across 200 apartments by Using our Alternative Bracket.

On average, every metric ton of steel produced led to 1.85 metric tons of CO2 released into the atmosphere in 2020

Brand	Generic	Brand	Box Strap
Type	Telescopic Bracket	Type	Double Box
Dimensions	L 440 mm x W 26 mm x D 13.8 mm	Dimensions	H 34 mm x W 50 mm x L 207 mm
Material Thickness	0.6mm	Material Thickness	1mm
Material	Pre Galvanised steel	Material	Pre Galvanised steel
Packaging type	Bundle of 50 units	Packaging type	Bundle of 50 units
Weight	0.28kg	Weight	0.082kg
Steel reduction	N/A	Steel Reduction	70.7%
CO2 emissions	0.519kg CO2	CO2 emissions	0.152kg CO2

- On average, 35 brackets are used in every new build property in the UK construction industry.

- By using the Box Strap bracket, which is the lighter and smaller bracket, we are able to save approximately 12.81 kg of CO2 emissions for each new build property in the UK

- Using the Box Strap bracket also has other impacts in the fight to lower CO2 emissions that we haven't taken into consideration, such as:

- Transportation: The lighter weight and the size of the bracket means that more pallets can be transported in one trip.
- Storage: The smaller size of the bracket means that it takes up less space in storage.
- Packaging: The smaller size of the bracket also means that less cardboard is required for packaging, reducing the amount of waste generated and the associated CO2 emissions.
- Manufacturing in the UK: It contributes to lower CO2 emissions, it reduces the need for long distance transportation, resulting in reduced carbon emissions associated with shipping and logistics.

Overall, using the Box Strap bracket not only reduces CO2 emissions during production, but also has additional benefits that contribute to a more sustainable construction industry.

www.BoxStrap.co.uk
info@boxstrap.co.uk

WHERE INNOVATION BEGINS

Specification

Brand	Box Strap
Part No:	220514
Dimensions	H 34 mm x W 50 mm x L 207 mm
Inner Length	I/L 135 mm
Inner Height	I/H 26 mm
Inner Width	I/W 36 mm
Face Plates	36 mm x 50mm
Material Thickness	1mm
Material	Pre Galvanised steel
Packaging type	Bundle of 50 units
Weight	0.082kg
Steel specification	DX54 + Z100 to EN10346-2015
Single layer pull test	40kg - Refer to ADA fixings report
Double layer pull test	80kg - Refer to ADA fixings report
Manufactured to	ISO9001-2015

30mm Plasterboard - 80kg 15mm Plasterboard - 40kg

www.BoxStrap.co.uk
info@boxstrap.co.uk

WHERE INNOVATION BEGINS

Page 1 of 4

Recommended Installation Guide

Type of Screws Required

13mm Wafer Head Drywall screw	13mm Wafer Head Jack-point screw	25mm Countersunk cross head	40mm Countersunk cross head
-------------------------------	----------------------------------	-----------------------------	-----------------------------

Bracket installation

Double back box

Single back box



Mute/OmniRoom

OmniRoom is a room-in-room system for creating plug-and-play, fully flexible office spaces. It uses patented technological innovations and the benefits of adaptable architecture to offer an easy solution for building comfortable and reshapable spaces suitable for hybrid work environments.

The system allows users to create tailor-made rooms and spaces or choose from +50 preconfigured options designed to serve four main office functions. The collection includes workstations, phone booths, soundproof pods for focus work, conference rooms of different sizes, chillout areas, and even coffee points or cloakrooms.

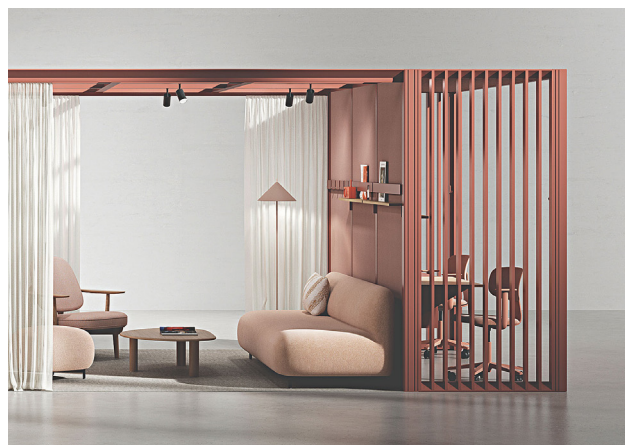

All rooms can be placed separately or combined into multifunctional hubs. The construction can be easily modified: users can create many structures from the same modules, ensuring the system fits current needs. Plus, every OmniRoom has ventilation, lighting, and electricity integrated. Closed rooms are also supplied with sound-insulating solutions.

Rooms can be furnished with wall-mounted add-ons from OmniRoom Furniture Set. All elements can be easily hung on any height of any wall, inside or out, and rearranged freely thanks to the specially designed hook system.

Judges' comments

OmniRoom is a multifunctional product that can adapt as the workplace changes. The easy click-in assembly system allows this product to be re-used easily with little need to re-purchase. The development of toolless connectors will make installation and reconfiguring an in-house operation. A good sustainable system.

SHORTLISTED



sponsored by
**SPEC
FINISH**

Eyevolution/Shadowline

Specially developed to create an invisible picture hanging space between plasterboard or masonry walls and plasterboard ceiling, Shadowline is a ceiling-integrated picture hanging system made from high-quality premium-grade materials.

This Shadowline ceiling system, which can be installed during the building or renovating phase, provides design flexibility and invisibility as it is hidden between the ceiling and the wall with a discreet shadow line being the only element that can be seen. Transparent hanging cords can be attached to the hidden picture hanging system so that the cords are suspended directly from the ceiling.

Judges' comments

The Shadowline solution, combined with the uplighting, is an innovative solution to prevent damaged walls and facilitates the need to recognise the requirement to hang art effectively and unobtrusively before the walls and ceilings are installed.

